

REXP142-23

EXTRUSION, PLASTER-IN PROFILE, 14MM HEIGHT,
20.7MM WIDTH, 2M, ALUMINIUM

PLEASE READ INSTRUCTION BEFORE COMMENCING INSTALLATION AND RETAIN FOR FUTURE REFERENCES.

! Electrical products can cause death or injury, or damage to property. If in any doubt about the installation or use of this product, consult a competent electrician

Note:

Product technical information and specification may change over time without prior notification. For the latest technical information please visit our web site www.robust.com or robustdirect.com, robust.com.au

1. Installation must be before plaster has been applied to plasterboard
2. Ensure mains supply is switched off before commencing work
3. Choose desired location to mount the extrusion, ensure that the cables are long enough to reach the start of the strip
4. Ensure that recessed dimensions in the ceiling/ plaster board are achievable (29mm x 10mm)
5. Mark our cut-out channel in the ceiling. Before cutting, ensure that the channel does not impinge on joists, pipe work, cables or other building services.
6. Remove diffuser and attach end caps. Place extrusion in the channel. Using screws, fix extrusion in the channel and ensure it is secure
7. Feed cable through hole in the end cap. Place LED strip inside aluminium channel and remove self-adhesive film, press the strip into the extrusion, ensure it is secure. Attach diffuser, ensure it is correctly attached

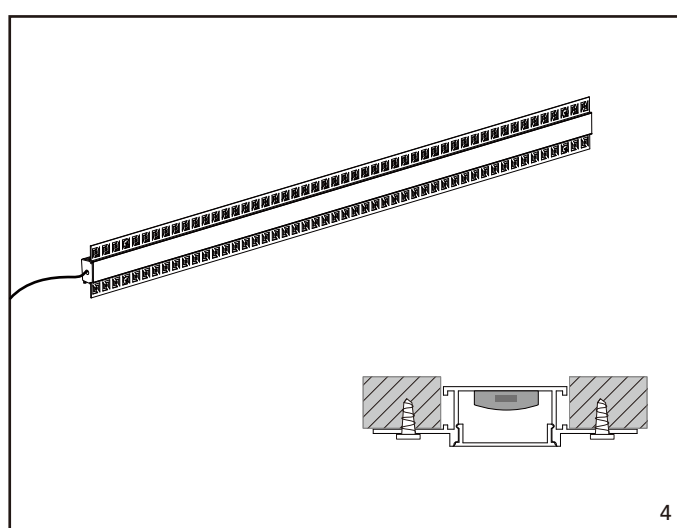
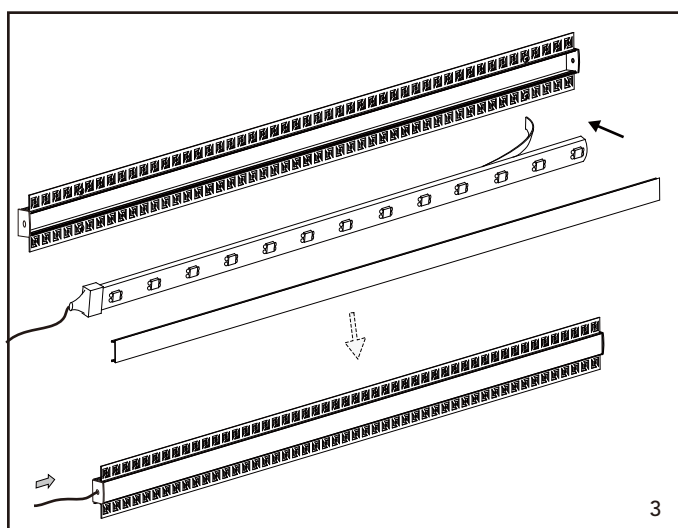
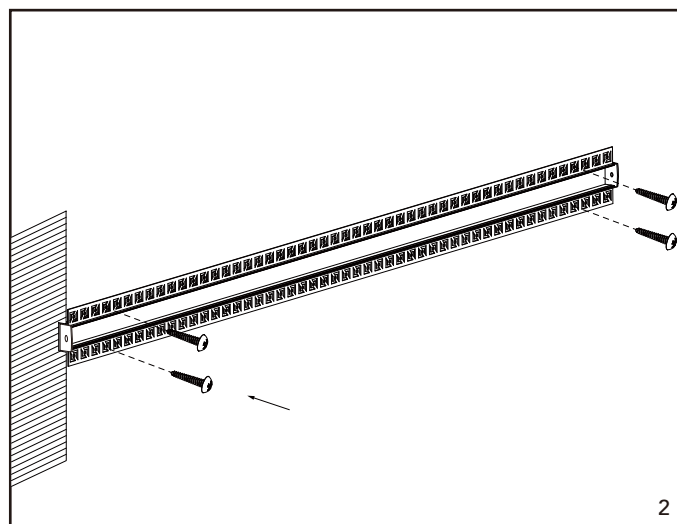
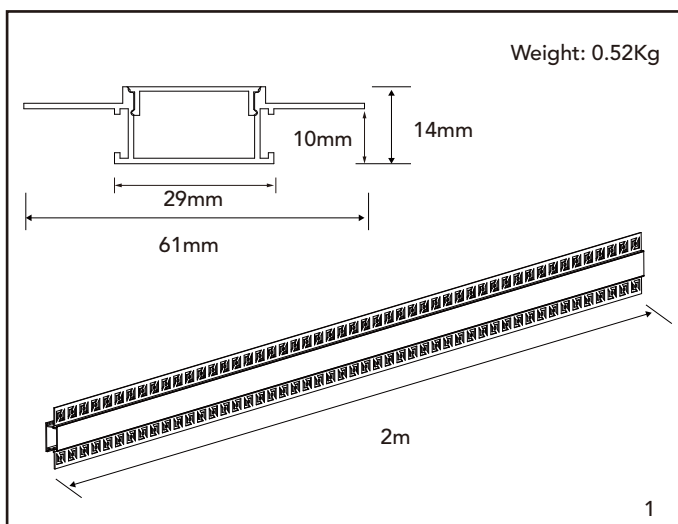

The Installation must be carried out by an electrician